

# LED Slim Panel Ecomax G4

# OPPLE

Version date 21-07-2022  
www.opple.com





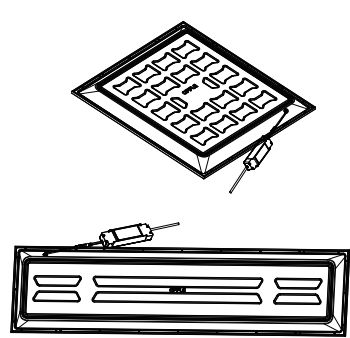
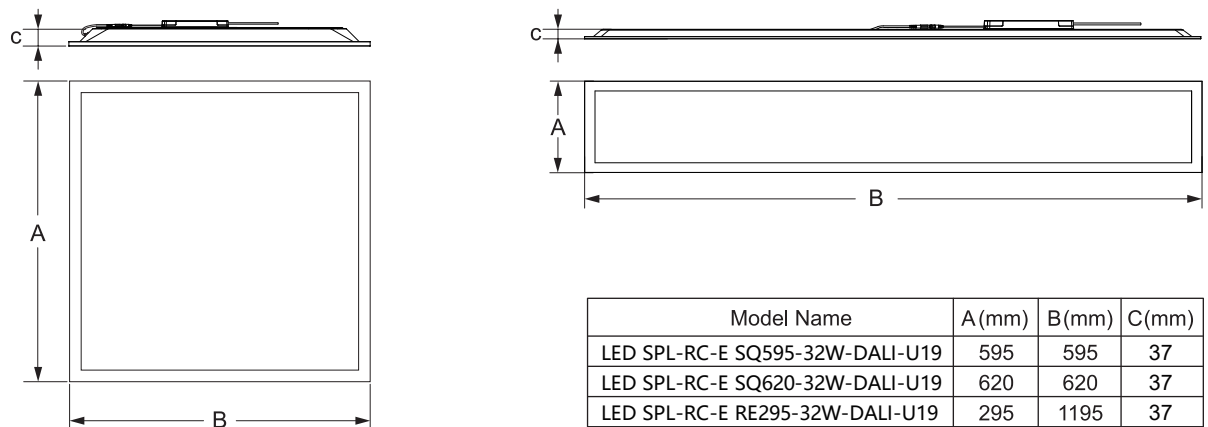



Item Code	Luminaire Description	CCT	kg
542003099100	LEDPanelS-E4 Sq595-32W-DALI-830-U19	3000K	1.92kg
542003099200	LEDPanelS-E4 Sq595-32W-DALI-840-U19	4000K	1.92kg
542003099300	LEDPanelS-E4 Sq620-32W-DALI-830-U19	3000K	2.15kg
542003099400	LEDPanelS-E4 Sq620-32W-DALI-840-U19	4000K	2.15kg
542003099500	LEDPanelS-E4 Re295-32W-DALI-830-U19	3000K	1.84kg
542003099600	LEDPanelS-E4 Re295-32W-DALI-840-U19	4000K	1.84kg
542003021700*	LEDPanelRc-S-B2 Suspension-Kit	/	0.25kg
542003021800*	LEDPanelRc-S-B2 Mounting-Springs	/	0.1kg
542098033000*	LEDPanelRc-S-B2 Re298 Mounting-Springs	/	0.126kg

\* Accessories should be purchased separately.

Model Name	A(mm)	B(mm)	C(mm)
LED SPL-RC-E SQ595-32W-DALI-U19	595	595	37
LED SPL-RC-E SQ620-32W-DALI-U19	620	620	37
LED SPL-RC-E RE295-32W-DALI-U19	295	1195	37

## Light Source

Product Code	Product Description	N	Light source code	QR Code	Energy Label
542003099100	LEDPanelS-E4 Sq595-32W-DALI-830-U19	6	LS030003212-01		
542003099300	LEDPanelS-E4 Sq620-32W-DALI-830-U19	6			
542003099200	LEDPanelS-E4 Sq595-32W-DALI-840-U19	6	LS030003215-01		
542003099400	LEDPanelS-E4 Sq620-32W-DALI-840-U19	6			
542003099500	LEDPanelS-E4 Re295-32W-DALI-830-U19	2	LS030003212-02		
542003099600	LEDPanelS-E4 Re295-32W-DALI-840-U19	2	LS030003215-02		

## Wire Connection & Recessed Installation

①

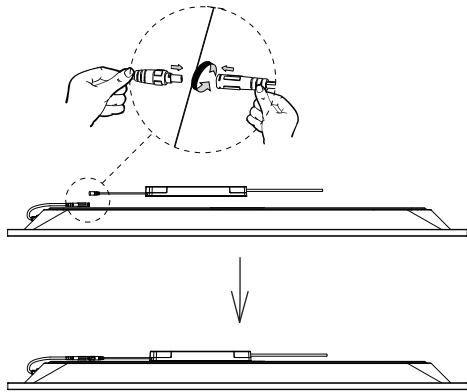

②

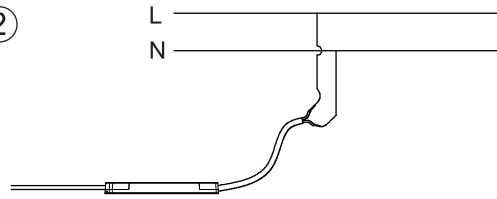

③

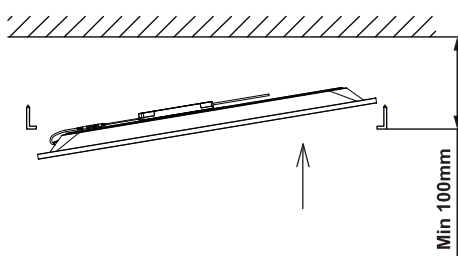

④

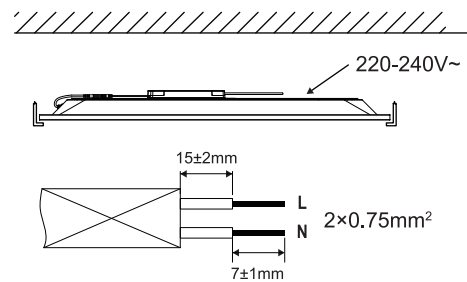

Terminal block not included. Installation may require advice from a qualified person. Only use suitable connection boxes with internal terminal blocks conform to EN60998-2-1 or EN60998-2-2 Terminal should be capable for at least 450V 16A, 0.75mm<sup>2</sup> wiring.

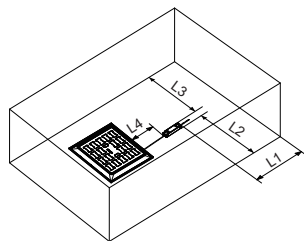

Type	L1(mm)	L2(mm)	L3(mm)	L4(mm)
SQ595				
SQ620	≥500	≥500	≥500	≤450
RE295				

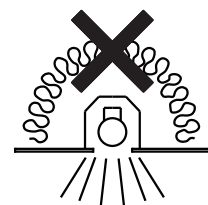
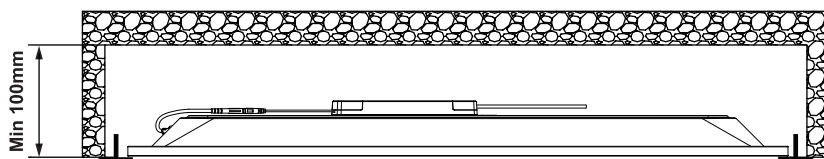

Do not cover with insulation material

## TOUCH DIM FUNCTIONALITY (For DALI2 System)

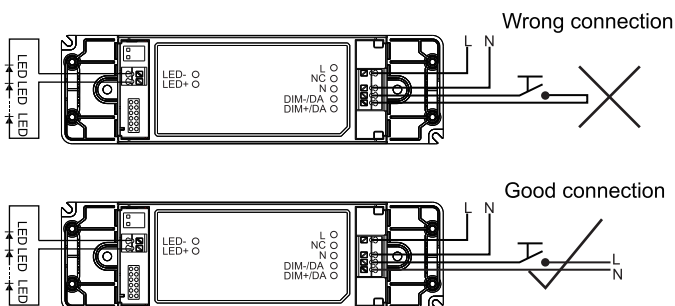

Function	Contact Duration	Reaction
Ignore	< 50ms	Nothing
Short Push	50-500ms	Turn on or off
Long Push	> 500ms	Dimming up or down
Synchronisation	10s	Go to SYNC level, 50%
	20s	Go to SYNC level, 100%

Touch Dim Terminal Consumption: Typical 3mA(220V).

Warning: TD function and DALI function can't be used at the same time, avoid damaging the DALI system by high voltage.

## Recessed Mounting (Lay-in) For DALI

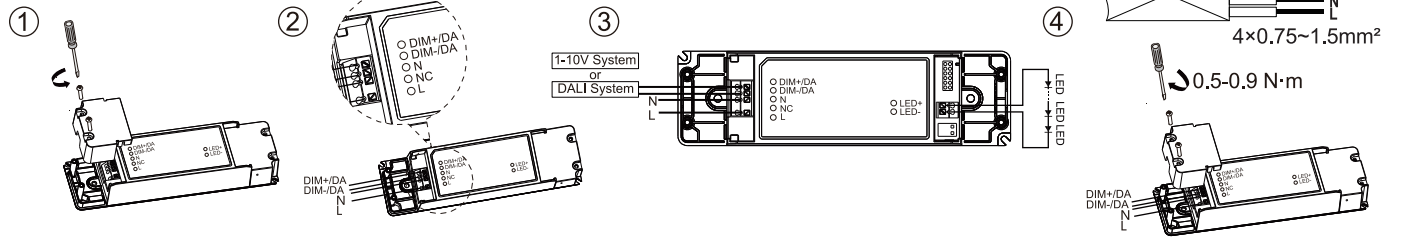

## Suspended Installation (Suspension kit)

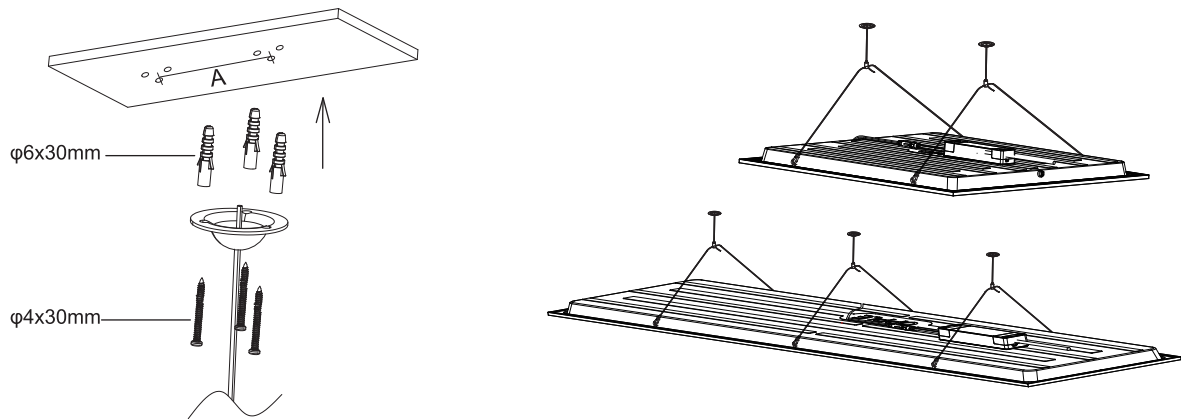

<b>Panel LED</b>	<b>A</b>	
595x595	331mm	x2 x4

<b>Panel LED</b>	<b>A</b>	
620x620	331mm	x2 x4

<b>Panel LED</b>	<b>A</b>	
295x1195	208mm	x3 x6

## Recessed Mounting (Mounting Springs)

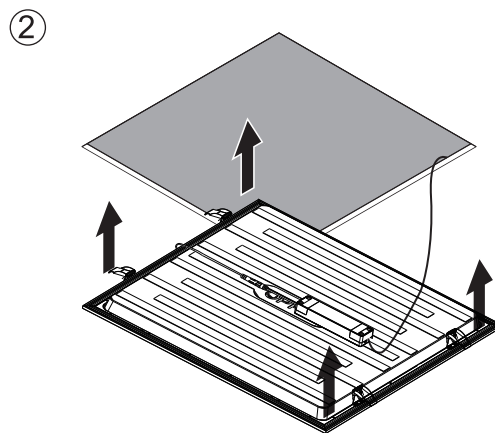
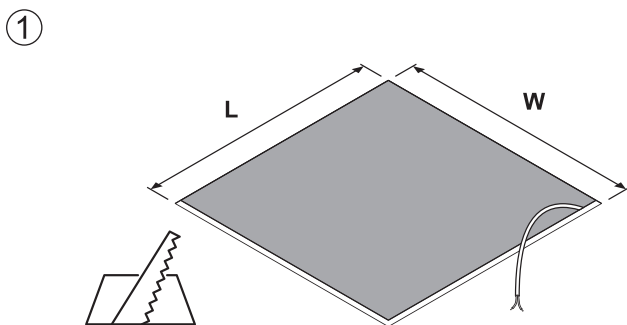
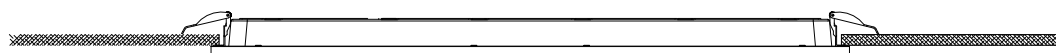

<b>Panel LED</b>	<b>L</b>	<b>W</b>	
595x595	580mm	580mm	x4 x8

<b>Panel LED</b>	<b>L</b>	<b>W</b>	
620x620	597mm	597mm	x4 x8

<b>Panel LED</b>	<b>L</b>	<b>W</b>	
295x1195	280mm	1180mm	x6 x12

## Recessed Mounting (Clips) For DALI

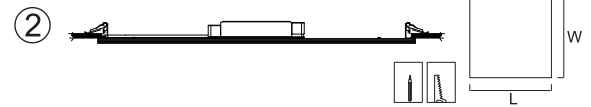
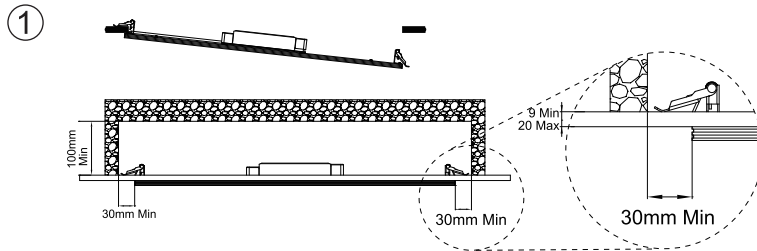

Type	L(mm)	W(mm)
SQ595	580	580
SQ620	580	580
RE295	1180	280

Clips should be purchased separately as accessory

### Caution

The luminaire is only suitable for safety extra low voltage supply (<50Va.c.; <120Vd.c.).

The controlgear for the connection panel should be SELV.

It must be basic insulation between FELV and SELV, as is FELV and LV supply for 1-10V and DALI type.

For non-user replaceable light sources:

The light source contained in this luminaire shall only be replaced by the manufacturer or his service agent or a similar qualified person.

Terminal block not included. Installation may require advice from a qualified person.

Only use suitable connection boxes with internal terminal blocks conform to EN60998-2-1 or EN60998-2-2 Terminal should be capable for at least 450V 16A, 0.75mm<sup>2</sup> wiring.

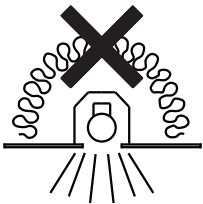

Luminaires not suitable for covering with thermally insulating material.  
Leuchten sind nicht mit thermisch isolierenden Materialien abzudecken.

In case of damage to the wire, it has to be replaced only by the manufacturer, distributor or by an expert, to avoid risks.



Caution: Any operation on LED module is forbidden while power-on.

Zur Vermeidung von Risiken müssen defekte Leitungen ausschließlich vom Hersteller, Inverkehrbringer oder Fachmann ausgetauscht werden.

Achtung: In Betrieb ist keine Arbeit am LED-Modul erlaubt.



Data subject to change  
Les données sont sujettes à modifications  
Änderungen vorbehalten

Suzhou Oppl Lighting Co., Ltd.  
215200  
East Side, Fenyang Road,  
Fenhu Economic Development Zone,  
Wujiang City, Jiangsu Province,  
P.R.China

Oppl Lighting BV  
Meerenakkerweg 1.11  
5652 AR Eindhoven  
The Netherlands  
service@oppl.com  
www.oppl.com